

Smart LogBox-A

EMBox

Quick Installation Guide

Issue: 1.0

Date: 2024-02-04

FOXESS CO., LTD.



Notice

1. The information in this document may not be modified, copied or reproduced, in whole or in part, without the prior written permission of FOXESS CO., LTD. All information in this document is provided to the best of our knowledge and efforts, but does not constitute a warranty of any kind, express or implied. You can download quick guide and user manual by scanning the QR code.



2. Only certified electricians are allowed to operate the device. Operation personnel must wear proper personal protective equipment (PPE).
3. Before installing the device, check that the package contents are intact and complete against the packing list. If any damage is found or any component is missing, contact your dealer.
4. The device damage caused by the violation of instructions in this document is not covered under warranty.
5. The cable colors involved in this document are for reference only. Select cables in accordance with local cable specifications.

1 Packing List

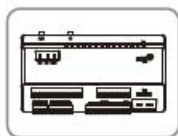

A



B



C



D



E

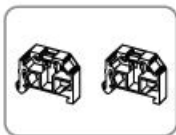

F



G



H

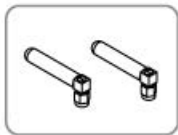

I

OBJ	QTY	DESC	OBJ	QTY	DESC
A	1	EMBox	B	1	Quick Installation Guide
C	2, 2	ST 4.8*19, Self-tapping Screw, Expansion Tube	D	2	Hexagon Bolt M4*16, Flange Nut M4
E	1	Guide Rail (Length: 250mm)	F	2	Terminal Fastener
G	8	Terminal Resistor	H	6	Cable Tie
I	2	Antenna			

2 Required Tools



Safety Goggles

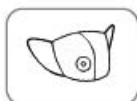

Dust Mask



Insulating Gloves



Tape



Phillips-Head Screwdriver



Flat-Head Screwdriver



Wire Stripper



Electric Drill



Rubber Mallet



Marker



DANGER:

Special care must be taken to protect personal safety. PPE must be worn during transfer and installation.



WARNING:

Please use proper protective measures, such as foam or protective cloth, keep the EMBox well protected from hard objects that may damage their exterior appearance or body during handling and installation.

3 Application Scenario

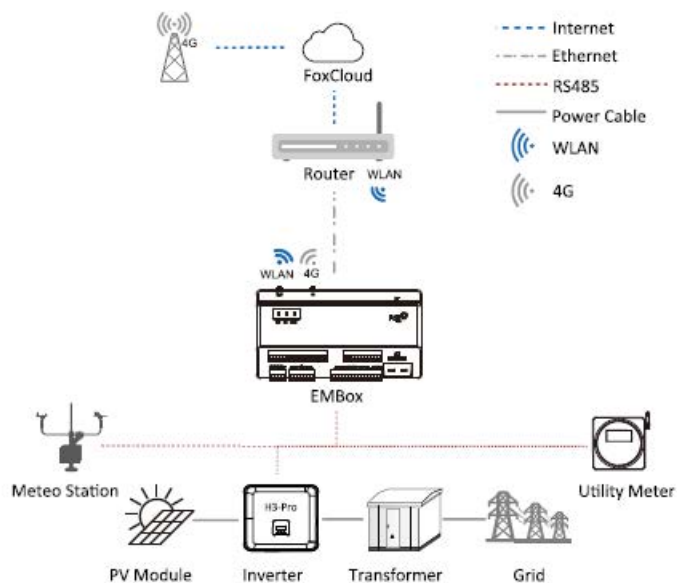

NOTICE

The EMBox can be connected to FoxCloud via any of a combination of Ethernet, WiFi and 4G.

4 Mechanical Installation

4.1 Installation Environment and Space

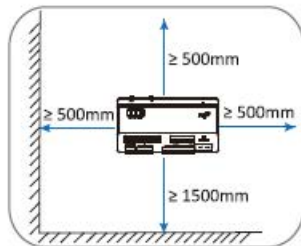

4.2 Installation

Method 1: Wall-Mounting

1

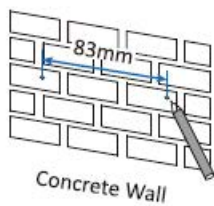

OR

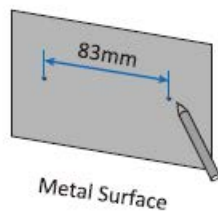

2

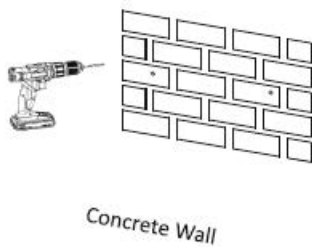

OR

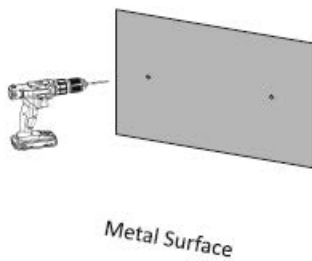

3

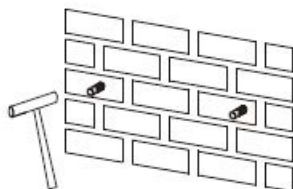

4

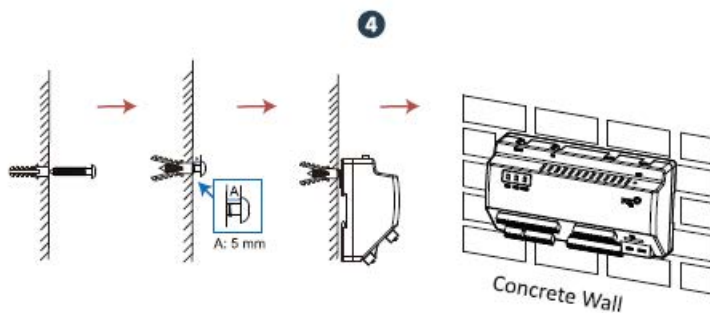

OR

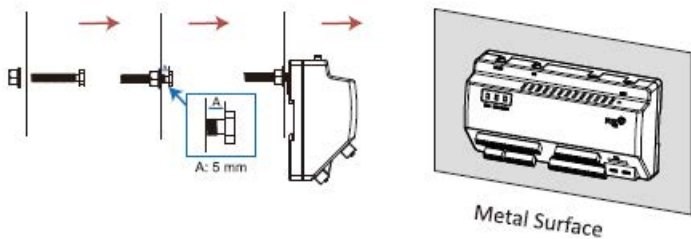

Method 2: Guide Rail-Mounting

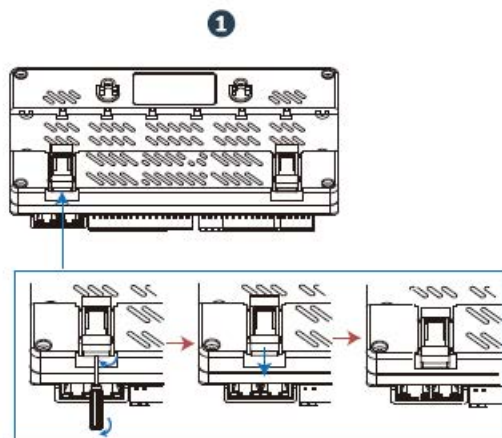

5

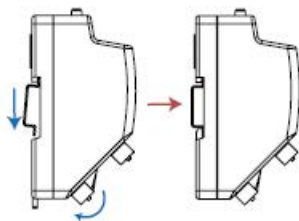
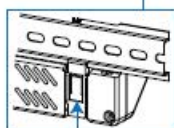
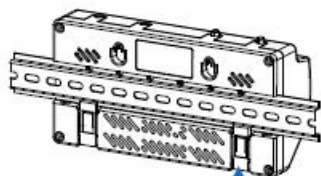
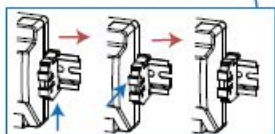
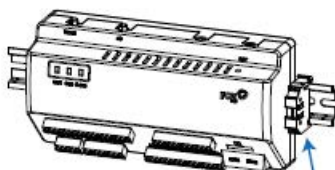
2**3****4**

4.3 Antenna Installation

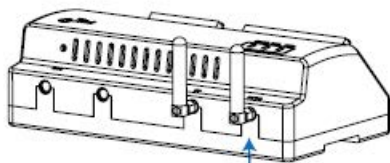
**6**

5 Electrical Connection

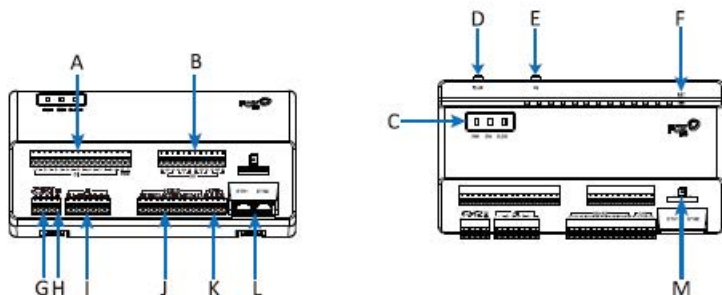

OBJ	LABLE	DESC
A	DI/DRM	Digital Input/Demand Response Modes Function
B	DO	Digital Output
C	RUN/COM/CLOUD	Indicators
D	WLAN	WLAN Antenna
E	4G	4G Antenna
F	RST	Reset Button
G	DC OUT/IN (10~27V)	Power Output/Power Input
H	PE	Grounding
I	AI	Analog Input
J	RS485	RS485 Communication Port
K	CAN	CAN Communication Port
L	ETH	Ethernet Port
M		SIM Card Slot

5.1 RS485 Connection

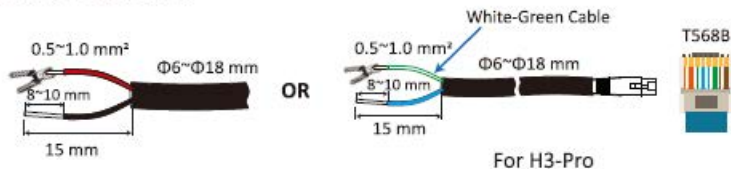

Inverter Connection

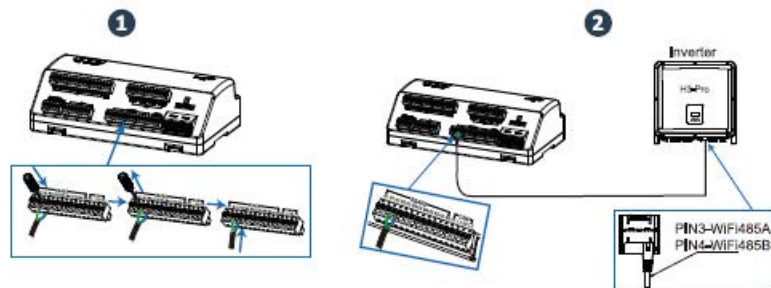

NOTICE

Connect the inverter to terminal RS485A2 and RS485B2 of EMBox via cable.
This guide uses the H3-Pro model as example to illustrate the RS485 connection between the EMBox and inverter.
An resistor should be inserted into inverter excepting H3-Pro in RS485 connection.

Meter Connection

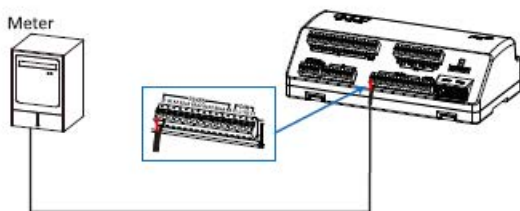

NOTICE

Connect the meter to terminal RS485A1 and RS485B1 of EMBox via cable.

5.2 Internet Connection

Method 1: 4G

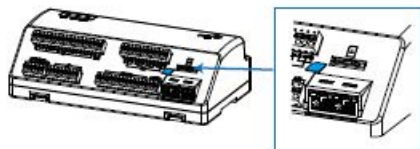

Method 2: WLAN

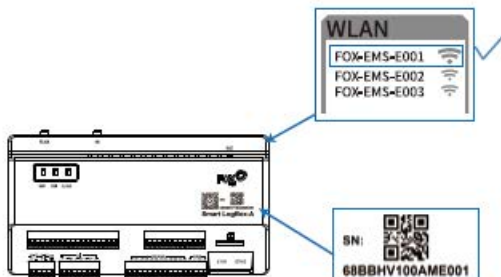

Method 3: Ethernet

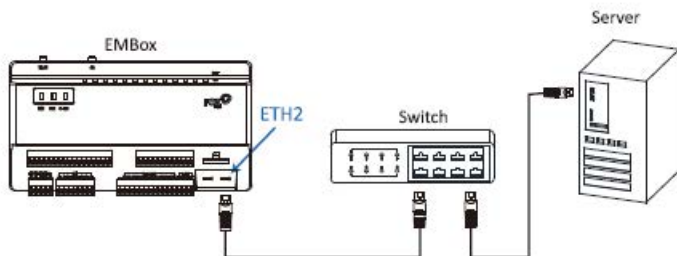

5.3 Power Supply

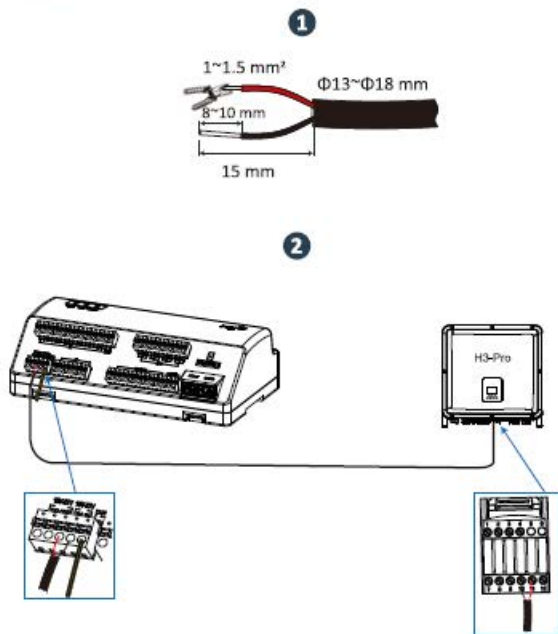

6 Commissioning

6.1 Power on



6.2 Internet Configuration Preparation

Method 1 : WiFi AP



Method 2: Ethernet



Method 3: Bluetooth

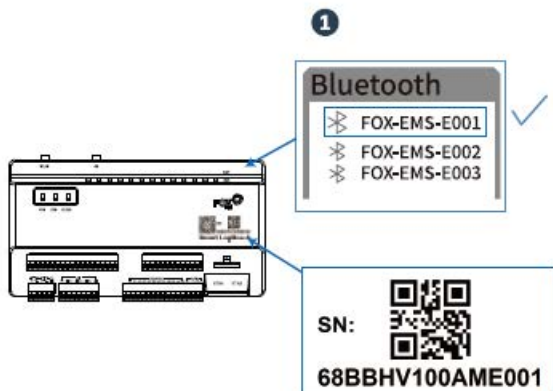

2

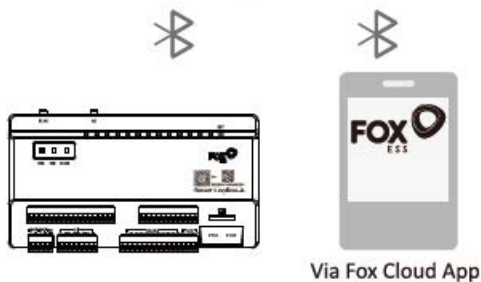

6.3 Web Configuration

1



2

Default type is Auto DHCP.

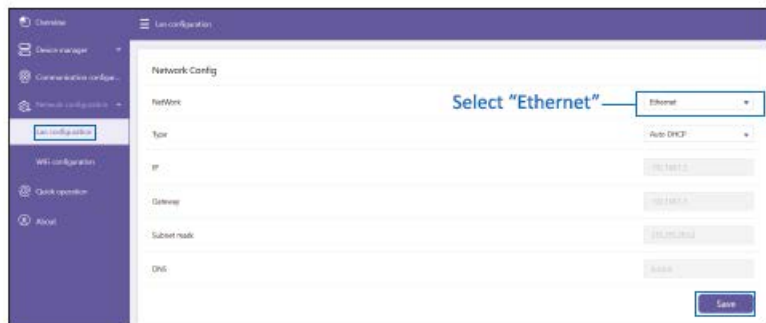

12

3



6.4 Create Site



Web: www.foxesscloud.com

1

No.	SN	Site	Host	Site connected Time	Country/Region	Status	Operation
1	FOX-ESS-SH-001	SH-001	SmartLogger	2023-04-14 14:04:17 (UTC+8:00)	China	●	⌵ ⌵



Method 1: Configure Address Automatically

No.	SN	Site	Host	Site connected Time	Country/Region	Status	Operation
01	0000000000000000	0000000000000000	0000000000000000	0000000000000000	0000000000000000	Automation	⌵ ⌵
02	0000000000000000	0000000000000000	0000000000000000	0000000000000000	0000000000000000	Automation	⌵ ⌵
03	0000000000000000	0000000000000000	0000000000000000	0000000000000000	0000000000000000	Automation	⌵ ⌵
04	0000000000000000	0000000000000000	0000000000000000	0000000000000000	0000000000000000	Automation	⌵ ⌵

13

Address allocation

Increment
 Full amount

* Port
Please enter the port

* Maximum number of devices
Please enter the maximum number of devices

Input by user

Cancel OK



NOTICE

Select Increment mode or Full amount mode according to user's need.

Increment: Distribute addresses to new sub devices.

Full amount: Reset all sub devices' addresses and distribute addresses to new sub devices.

Method 2: Configure Address Manually

Move Options

Address: 192.168.1.100

Device ID	1	2	3	4
SN	0000000000	0000000000	0000000000	0000000000
SN	0000000000	0000000000	0000000000	0000000000
Address	0000000000	0000000000	0000000000	0000000000
Search	Automation	Automation	Automation	Automation



Create manually

* SN: 00

* Group: Please select a group

* ID: Please enter ID

* Address: Please enter your address

* Inverter Model: inverter source

* enable device address recognition: no yes

* disable the device: no yes

Input by user

Cancel OK

2

Input by user

Select Type:

Site Setting

Agent:

City:

Team Zone:

Country:

Site Name:

Address:

PG Size:

Capacity / Region:

Network:

Health Self:

To install a device:

UK:

IV Charger (optional):

UK:

EVSE Meter (optional):

UK:

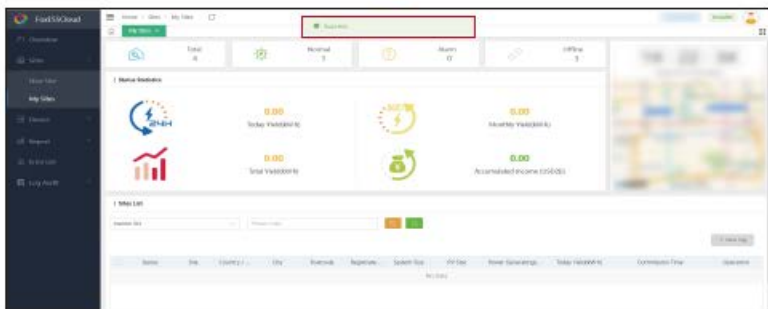

V1.0
99-203-00281-00